

# PL Series

## Precedent Performance LED Linear Series

### Specifications/Features

The ConTech Precedent PL Performance Linear Series Luminaires offers an innovative LED solution for general illumination in grocery, retail, and other aisle environments. Custom designed optics provided varied distributions to allow for superior beam control and lighting uniformity in both vertical and horizontal planes. Fixtures deliver up to 1,500lm per foot at 3000K, 90+CRI ensuring superior lighting coverage, consistency and glare control.

#### Housing

Extruded aluminum housings in 4' and 8' sections come complete with quick connects between units to allow for easy runs of multiple fixtures.

Available in standard white, black, or silver finishes.

Construction allows for installation in both new and retrofit environments.

Construction allows for suspended or surface mounting.

10' and 20' field adjustable aircraft support accessories available.

Body construction accepts 1/4" threaded rod (rod and hardware provided by others).

Accessory to accept up to 1/2" threaded rod available.

Body construction accepts standard 1/2" electrical fittings and mounting hardware (provided by others) for surface mounting applications. Optional horizontal louvers.

#### Lamp/Electrical

Light engine consists of 4' LED boards designed with integrated thermal management components.

Available in four CCT's and 83+ or 90+CRI. Excellent color consistency within a 3-step MacAdam Ellipse tolerance.

120-277V, 50/60Hz input

Single, Two, or Three Circuit wiring as well as 0-10V dimming control options

Available in three lumen packages (outputs at 90+CRI):

Lumen Series	4' Fixture	8' Fixture
Series 1	28W, 3200 Lumens	57W, 6400 Lumens
Series 2	40W, 4400 Lumens	81W, 8800 Lumens
Series 3	57W, 6000 Lumens	113W, 12000 Lumens

#### Optics

Three custom designed optics designed to provide industry leading illumination levels and consistency.

- **Flood** optic designed to provide general illumination in both the horizontal and vertical planes.
- **Shelf/Stack** optic designed to deliver industry leading illumination consistency across a 7 foot vertical plane while providing general aisle floor illumination
- **Asymmetric** optic designed to deliver consistent vertical illumination to either the left or the right of center allowing for wall washing or single sided aisle lighting

#### Warranty

This complete fixture is covered by ConTech's full five (5) year replacement guarantee after date of purchase.

#### Listing

cCSAus Certified for use in the U.S. and Canada. Fixture must be installed in accordance to all product specific installation instructions and appropriate National electrical Codes.

Assembled in the U.S.A.

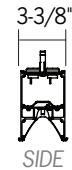
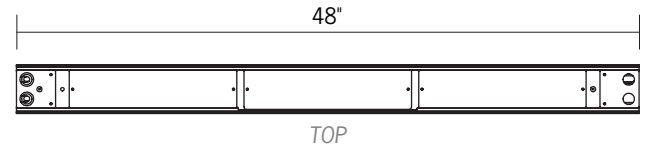

Wattage/Lumen Package	Maximum Run Length	
	120V	277V
Series 1	204ft	460ft
Series 2	136ft	320ft
Series 3	104ft	232ft

# PL Series

## Precedent Performance LED Linear Series

### Ordering Information

#### Example Aisle Bill of Material

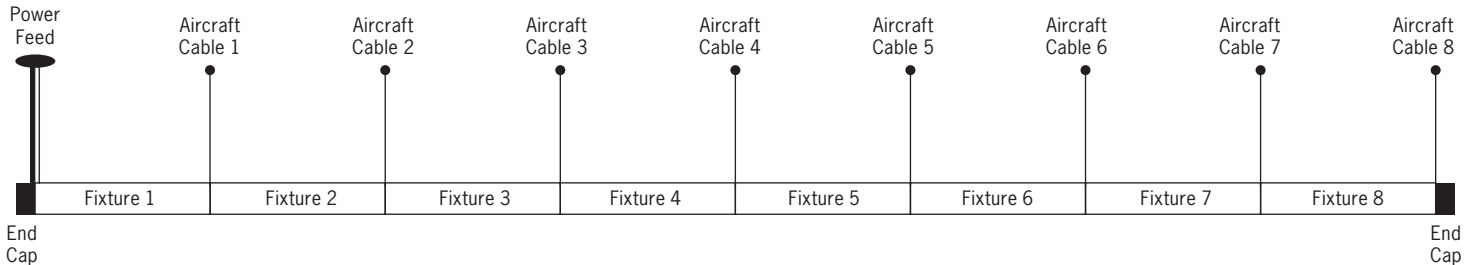

64 Ft. Aisle with one control drop, 0-10V dimming, 1500lm/Ft, 3000K, 90+ CRI, white finish

**Fixtures:** (8) PL8330KCS1CMVD2-P

**Power Feed:** (1) PLF1CD210-P

**Supports:** (8) PLSAC10-P

### Performance Linear Fixture

Fixture Length	Light Engine Series	Color Temp	Beam Distribution	Circuit Control	Driver/Dimming	Battery Backup	Finish
<b>PL4</b> - 4FT/48" <b>PL8</b> - 8FT/96"	<b>1</b> - 800lm/7W per FT <b>2</b> - 1200lm/10W per FT <b>3</b> - 1500lm/13W per FT	<b>27K</b> - 2700K <b>30K</b> - 3000K <b>35K</b> - 3500K <b>40K</b> - 4000K <b>27KC</b> - 2700K, 90+CRI <b>30KC</b> - 3000K, 90+CRI <b>35KC</b> - 3500K, 90+CRI <b>40KC</b> - 4000K, 90+CRI	<b>F</b> - Flood <b>S</b> - Shelf/Stack <b>A</b> - Asymmetric	<b>1C</b> - Single Circuit Wiring <b>2C</b> - Two Circuit Wiring <b>3C</b> - Three Circuit Wiring	<b>MV</b> - 120V - 277V No Dimming <b>MVD2</b> - 120V - 277V 0-10V Dimming	- No Battery, Leave Blank <b>EM</b> - Emergency Battery	<b>B</b> - Black <b>P</b> - White <b>S</b> - Silver

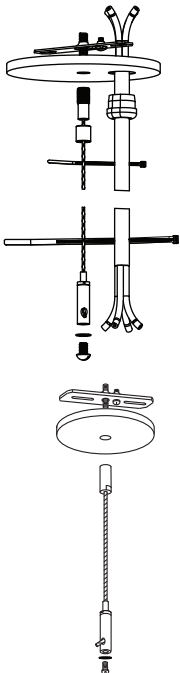

### Power Feed Canopy Set

Includes Canopy, Power Supply Cable(s), Mounting Hardware, (1) Aircraft Cable Support, Fixture End Cap Set

Performance Linear Feed	Circuit Control	Dimming Control Feed	Battery Back-Up	Length	Finish
<b>PLF</b>	<b>1C</b> - Single Circuit Wiring <b>2C</b> - Two Circuit Wiring <b>3C</b> - Three Circuit Wiring	- No Dimming Leave Blank <b>D2</b> - 120V - 277V 0-10V Dimming	- None Leave Blank <b>EM</b> - Emergency Battery Feed	<b>10</b> - 10ft Drop <b>20</b> - 20ft Drop	<b>B</b> - Black <b>P</b> - White <b>S</b> - Silver

### Fixture Support System

Includes Canopy, Adjustable Aircraft Support Cable, and Mounting Hardware

Performance Linear Support	Type	Length	Finish
<b>PLS</b>	<b>AC</b> - Aircraft Cable	<b>10</b> - 10ft Drop <b>20</b> - 20ft Drop	<b>B</b> - Black <b>P</b> - White <b>S</b> - Silver

### Accessories

--

**PLLOUVER2-(B,P,S)** - 2FT Snap-in Louver; Black, White, or Silver Finish

**PLSTH** - Threaded Rod Support Kit; Brackets with Hardware, for use with 3/8" - 1/2" Threaded Rod

**PLEC-(B,P,S)\*** - End Cap Set (Includes Two (2) End Caps for Full Run and Mounting Hardware); Black, White, or Silver Finish

**PLJK-(B,P,S)\*\*** - Joiner Kit (Includes Fixture Joiner Bracket Hardware and Light Leak Shields); Black, White, or Silver Finish

\*Complete End Cap Set Included with Every Power Feed Set

\*\*Complete Joiner Kit Included with Every Fixture

# PL Series

## Precedent Performance LED Linear Series

### Photometrics

All photometric reports provided using Series 3 Fixtures with 3000K, 90+CRI LEDs. For other configurations please use below multipliers to adjust light outputs.

**Multipliers:**

Series 1: 0.53

Series 2: 0.78

CCT	CRI	
	90+ CRI	80+ CRI
2700K	0.98	1.12
3000K		1.13
3500K	1.01	1.15
4000K	1.05	1.15
5000K	N/A	1.21

### PL4330KCS1CMVD2

Designed for 50,000 Hour Lamp Life!; LM-63 Test No. 89001

Light Output (Fixture Delivered Lumens): 5756  
 Total Watts@120V: 59.3  
 Lumens Per Watt: 97.1  
 Color Rendering Index (CRI)<sup>1</sup>: 90+  
 Color Temperature (CCT)<sup>2</sup>: 3000K  
 Beam Distribution: 19.1° @ 90°  
 Spacing Criteria: 0.99 @ 90°

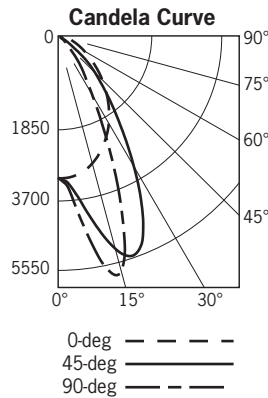

#### Candlepower Summary

	CANDELLA FROM 0	CANDELLA FROM 45	CANDELLA FROM 90	LUMENS
0	2588	2588	2588	
5	2574	2817	3085	294
15	2379	4718	5655	1187
25	2022	4563	2115	1481
35	1581	2123	781	1200
45	1134	964	208	827
55	744	243	71	471
65	448	55	43	210
75	235	27	22	71
85	68	7	6	15
95	0	0	0	

### PL4330KCF1CMVD2

Designed for 50,000 Hour Lamp Life!; LM-63 Test No. 88397

Light Output (Fixture Delivered Lumens): 6124  
 Total Watts@120V: 60.5  
 Lumens Per Watt: 101.2  
 Color Rendering Index (CRI)<sup>1</sup>: 90+  
 Color Temperature (CCT)<sup>2</sup>: 3000K  
 Beam Distribution: 88° @ 0°  
 Spacing Criteria: 1.15 @ 0°

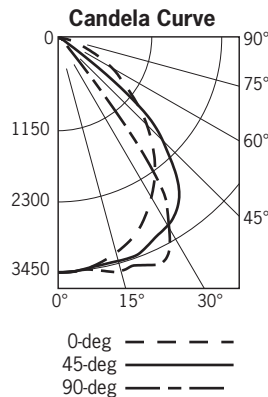

#### Candlepower Summary

	CANDELLA FROM 0	CANDELLA FROM 45	CANDELLA FROM 90	LUMENS
0	3414	3414	3414	
5	3397	3391	3393	323
15	3208	3351	3498	945
25	2858	3201	3547	1468
35	2341	2924	2053	1546
45	1710	2007	123	982
55	1060	122	53	528
65	549	40	43	263
75	200	28	30	54
85	38	9	8	15
95	0	0	0	

### PL4330KCAICMV

Designed for 50,000 Hour Lamp Life!; LM-63 Test No. 88877

Light Output (Fixture Delivered Lumens): 5534  
 Total Watts@120V: 61  
 Lumens Per Watt: 90.7  
 Color Rendering Index (CRI)<sup>1</sup>: 90+  
 Color Temperature (CCT)<sup>2</sup>: 3000K  
 Beam Distribution: 27° (at 0°) x 33° (at 90°)  
 Spacing Criteria: 1.15 @ 0°

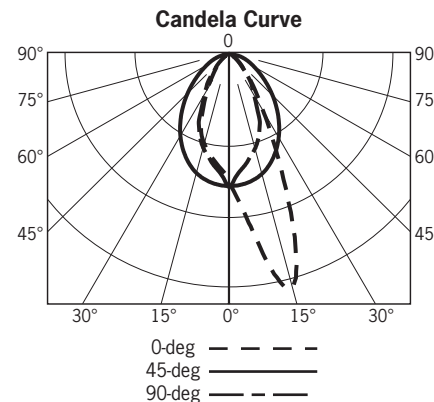

#### Candlepower Summary

	CANDELLA FROM 0	CANDELLA FROM 45	CANDELLA FROM 90	LUMENS
0	3364	3364	3364	
5	4104	3809	3337	336
15	6106	5357	3136	1062
25	2672	4897	2697	1335
35	984	2481	2109	1149
45	309	1172	1486	817
55	118	344	943	481
65	70	88	565	242
75	37	43	305	91
85	9	10	84	21
95	0	0	0	