

RFT6E Series

6" LED Retrofit Trim Module

Specifications/Features

6" LED trim module for use in new construction and retrofit light commercial and residential applications. Compatible with most 6" recessed housings (refer to housing compatibility section below).

Aluminum extruded heat sink designed to facilitate heat dissipation, ensuring consistent quality light output, color and life of solid state components. Driver mounts externally to the trim module for easy access and employs integral thermal protection.

Optical acrylic diffusion lens produces high lumen transmission and even illumination.

E26 medium screw base connector harness provides easy installation into new construction or retrofit applications.

Nickel plated steel torsion springs provide secure trim module retention in recessed housing.

Designed and rated for 50,000 hours at 70% lumen maintenance.

Reflector and baffle are fabricated from heavy gauge aluminum.

Injection molded plastic trim ring.

Lamp

Multiple LED chips with excellent fixture-to-fixture color consistency.

Warranty

This complete fixture is covered by ConTech's full five (5) year replacement guarantee after date of purchase.

Listing

ETL Listed or ETL Classified based upon housing compatibility (U.S. and Canada). Though retrofit trim module is rated for 120-277V AC, refer to fixture wiring restrictions before connecting.

Suitable for use in damp locations.

Housing Compatibility

ETL Listed for use with the following ConTech housings:

RL30-IC, RL30-ICSA-R, RL38, RL38-CP, RL38-ICER, RL38-ICESA

ETL Classified for use with the following housings:

Halo: H7ICAT, H7RICAT, H7ICT, H7RICT, H7ICATNB, H7ICTNB, H7T, H7RT, H7TNB, H7TCP, H7UICAT, H7UICAT

All Pro: EI700AT, EI700RAT, E700ATNB, EI700, EI700R, EI700ATNB, EI700NB, ET700, ET700R, EI700U, EI700UAT

Juno: IC22, IC22R, IC22W, IC22S, IC23, IC23W, IC21, IC21R, TC2, TC2R

Capri: CR1, PR1, QL1 **Lithonia:** L7X **Thomas:** PS1

Approved Dimmers

Lutron: NovaT NTELV300, NTELV600, Diva DVELV-300P, DVELV-303P

Leviton: Acenti ATE06-1L, Trimatron 705-I



Matte White Baffle

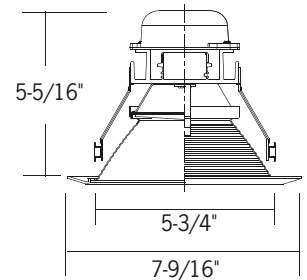

Input Voltage

Non-dimming	120-277VAC
-------------	------------

Dimming	120VAC
---------	--------

Input Wattage	13.8W
----------------------	-------

Color Temperature	3000K
--------------------------	-------

CRI (Typical)	80
----------------------	----

Power Factor	>0.90
---------------------	-------

THD	<20%
------------	------

Dimming

Triac	15-100%
-------	---------

Ordering Information

Example Order:

Trim Module



RFT6E130K-P - Matte White Baffle, 3000K, E26 Base

RFT6E Series

6" LED Retrofit Trim Module

Photometrics

RFT6E130K-P

Designed for 50,000 Hour Lamp Life*

Light Output (Fixture Delivered Lumens): 733
 Total Watts@120V: 13.8
 Lumens Per Watt: 53
 Color Rendering Index (CRI)¹: 80
 Color Temperature (CCT)²: 3000K

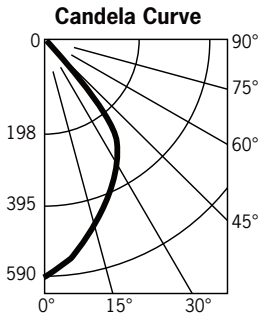

Candlepower Summary

FROM 0	LUMENS
0	
5	53
15	143
25	206
35	206
45	97
55	22
65	5
75	1
85	1
95	0

Intensity Distribution

DISTANCE (FT.)	FOOTCANDLES (FC)	BEAM DIAMETER (FT.)
2'	147.2	3.1
4'	36.8	6.1
6'	16.4	9.2
8'	9.2	12.3
10'	5.9	15.3
12'	4.1	18.4

Beam Distribution: 75°
Spacing Criteria: 1.5

1. Accuracy of rendering colors
 2. Color appearance of light source

*Dependent on surrounding temperatures